

# MagCodePowerSystem 12/24V

## Installation instruction MagCodePowerPort

### Important Notice!

An existing vehicle power outlet can be replaced by the **MagCodePowerPort** (same diameter). **Mounting in other places should be done by an authorized workshop!**

### Important: Remove fuse before start of installation!

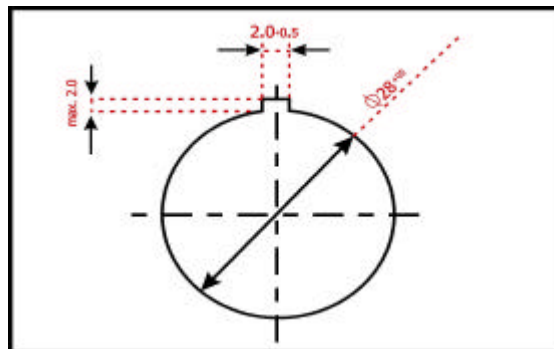
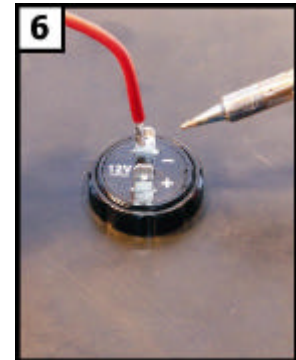
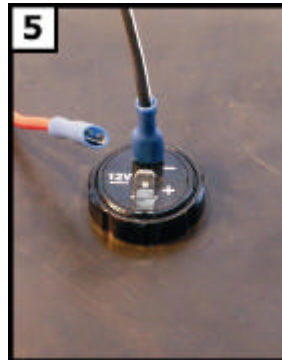
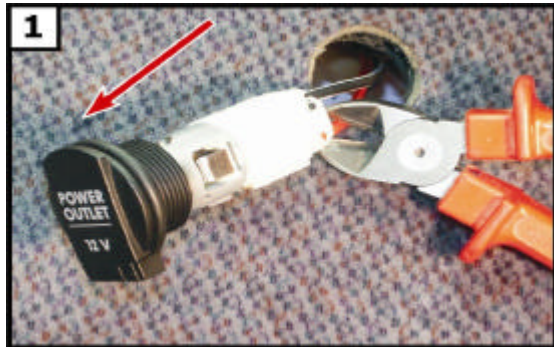

**TO AVOID SHORT- CIRCUIT, TAKE OUT FUSE BEFORE YOU START!**

#### Picture 1:

Pull out existing power outlet (notice polarity) and cut-off wires or ...

#### Picture 2:

... create new cut out.

#### Picture 3:

Place MagCodePowerPort , with or without fastener ring, in mounting cut out and ...

#### Picture 4:

...secure MagCodePowerPort with M28 fixing nut and ...

#### Picture 5/6:

...connect cables to vehicle harness (notice polarity) with quick-connect receptacles (6,3mm) or by soldering.

Insert fuse – Ready!

# MagCodePowerSystem 12/24V

## Installation instruction MagCodePowerClip

How to install?

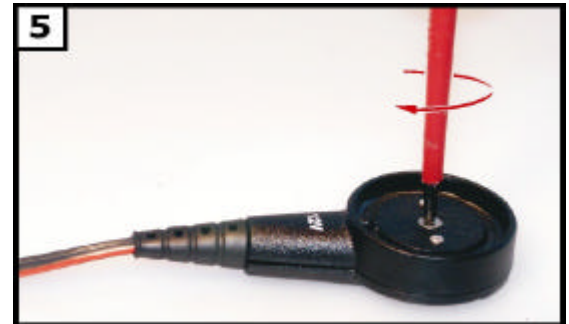
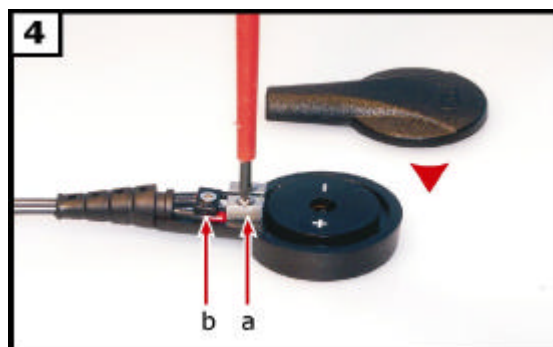
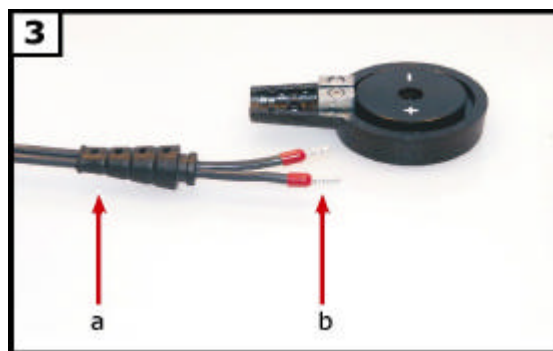

**Picture 1:**  
Cut-off existing plug – notice polarity.

**Picture 2:**  
Open MagCodePowerClip and remove pull relief.

**Picture 3:**  
Cut grommet to size for thicker cables (3a) and apply multicore wiring sleeves (3b).

**Picture 4:**  
Fix cable ends in screw terminals (4a) (notice polarity) and mount pull relief (4b) and grommet.

**Picture 5:**  
Close housing with screw - Ready!